

## DESJB1001

Adj mtg plate for CDTi "P-PLUS" junction box and plug

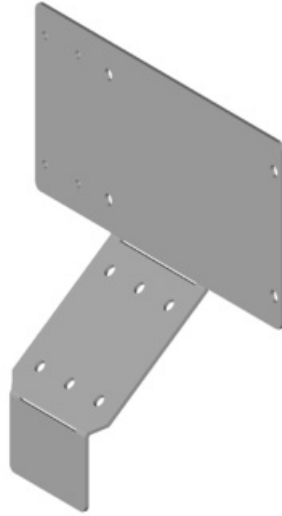

\*Due to continuous improvements to our products, actual items ordered and received may differ slightly from images shown.

### Features:

- Constructed from 11GA galvanized steel
- Mounting plate is provided un-bent with relief slots at the approximate center-line of each bend shown.
- Bracket can be put in a vise and bent to desired angle then welded and painted desired color

### Installation:

1. Position bracket in desired location, drill as needed, determine the angle needed, bend, and weld slots closed.
2. A gusset welded to the bracket after it is bent is recommended
3. Paint bracket as needed.